

Mark of modified	Modifier	Date

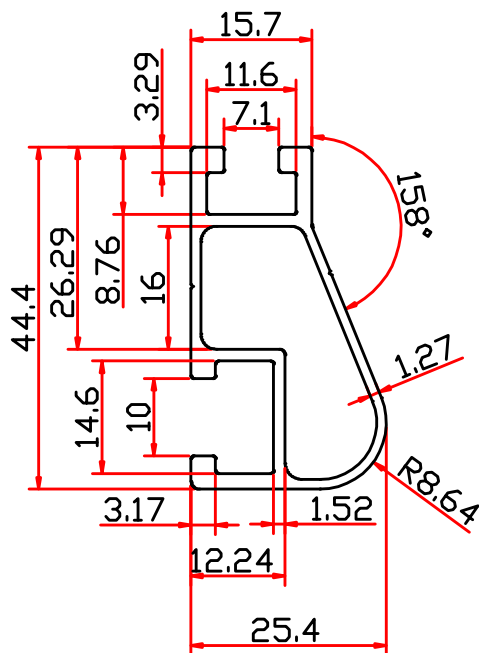

Exposed Surface - - - - -

1. This drawing is consistent with the customer's "samples / drawings", and the Demander shall be responsible for any patent or trademark matters.
2. If it is matched with other profiles or accessories, it is necessary to indicate or provide accessories. Otherwise, the assembly problems caused shall be borne by the customer.
3. The customer confirms the drawings, including confirming and approving the drawings, tolerances, acceptance standards, weight, decorative surface area and other information on the drawings.

Area of Exposed Surface: **0.110m²/m**

Drawn by LCG
Date 2023.06.05

Unspec. Thickness: $\frac{\text{mm}}{\text{in}}$ Unspec. Radius: $R0.3 \frac{\text{mm}}{\text{in}}$

Checked by
Date

1. * Important dimension.
2. () Referenced dimension.

GENERAL TOLERANCES

DIMENSION	LENGTH			BETWEEN HOLES AND PINS	ANGLES	RADIUS
	0-30	30-120	120-			
TOLERANCE	±0.2	±0.3	±0.4	±0.1	±0.5°	±0.1

Sectional Area	234.11 $\frac{\text{mm}^2}{\text{in}^2}$	Alloy/Tempor	6063-T6
Theory Weight	0.637 $\frac{\text{kg/m}}{\text{Lb/ft}}$	Scale	1:1
Out Perimeter	182.24 $\frac{\text{mm}}{\text{in}}$	Finish	
Circumscribed About circle	∅48 $\frac{\text{mm}}{\text{in}}$	Standard	GB 5237.1-2017

Confirmed by	Date	Series	TR	Profile appellation	
Delivery	Theory weight	6	/Bundle		
Precision	High Pre-cision	Edition	A		

CUSTOMER	Customer Draw No.	
Signed by	Our Draw No.	TR10

广西瑞祺丰新材料有限公司
Guangxi RuiQiFeng New Material Co.,Ltd.
TEL: 13980800771 E-mail: info@huiqifeng-artist.com

Mark of modified	Modifier	Date

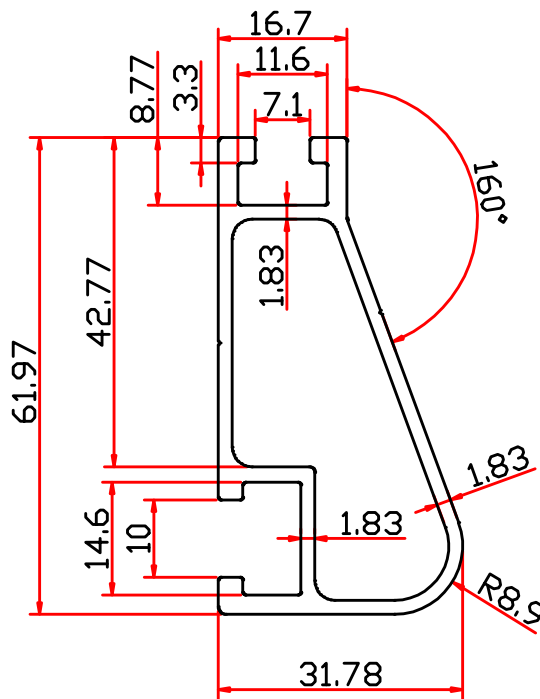

Exposed Surface - - - - -

1. This drawing is consistent with the customer's "samples / drawings", and the Demander shall be responsible for any patent or trademark matters.
2. If it is matched with other profiles or accessories, it is necessary to indicate or provide accessories. Otherwise, the assembly problems caused shall be borne by the customer.
3. The customer confirms the drawings, including confirming and approving the drawings, tolerances, acceptance standards, weight, decorative surface area and other information on the drawings.

Area of Exposed Surface: 0.1545m²/m

Unspec. Thickness: $\frac{\text{mm}}{\text{in}}$ Unspec. Radius: R0.3 $\frac{\text{mm}}{\text{in}}$

Drawn by LCC
Date 2023.06.05

Checked by
Date

Confirmed by
Date

Series TR Profile appellation

Delivery Theory weight 4 /Bundle

Precision High Pre-cision Edition A

Sectional Area	376.7 $\frac{\text{mm}^2}{\text{in}^2}$	Alloy/Tempor	6063-T6
Theory Weight	1.025 $\frac{\text{kg/m}}{\text{Lb/ft}}$	Scale	1:1
Out Perimeter	225.45 $\frac{\text{mm}}{\text{in}}$	Finish	
Circumscribed About circle	ø66.6 $\frac{\text{mm}}{\text{in}}$	Standard	GB 5237.1-2017

1. * Important dimension.
2. () Referenced dimension.

GENERAL TOLERANCES

DIMENSION	LENGTH			BETWEEN HOLES AND PINS	ANGLES	RADIUS
	0-30	30-120	120-			
TOLERANCE	±0.2	±0.3	±0.4	±0.1	±0.5°	±0.1

CUSTOMER	Customer Draw No.	Our Draw No.	TR100
Signed by			

广西瑞祺丰新材料有限公司
Guangxi Ruiqi Feng New Material Co., Ltd.
TEL: 13980800771 E-mail: info@huanan-artist.com

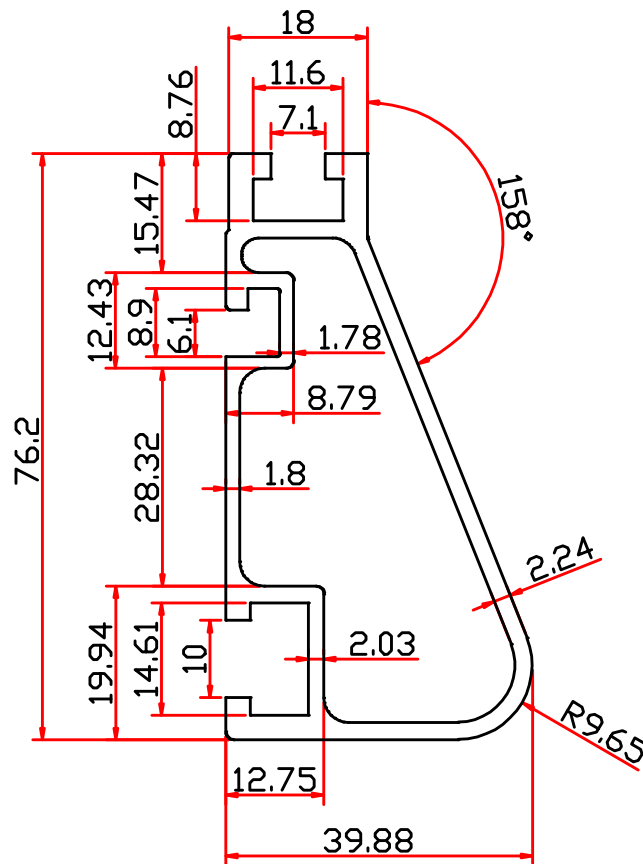

Exposed Surface - - - - -

1. This drawing is consistent with the customer's "samples / drawings", and the Demander shall be responsible for any patent or trademark matters.

2. If it is matched with other profiles or accessories, it is necessary to indicate or provide accessories. Otherwise, the assembly problems caused shall be borne by the customer.

3. The customer confirms the drawings, including confirming and approving the drawings, tolerances, acceptance standards, weight, decorative surface area and other information on the drawings.

Area of Exposed Surface: $0.1868 \text{ m}^2/\text{m}$

Drawn by LCQ
Date 2023.06.05

Unspec. Thickness: mm in Unspec. Radius: $R0.3 \text{ mm}$ in

Checked by
Date

- 1. * Important dimension.
- 2. () Referenced dimension.

GENERAL TOLERANCES

DIMENSION	LENGTH			BETWEEN HOLES AND PINS	ANGLES	RADIUS
	0-30	30-120	120-			
TOLERANCE	±0.2	±0.3	±0.4	±0.1	±0.5°	±0.1

Sectional Area	549.70 mm^2 in^2	Alloy/Temp	6063-T6	Confirmed by Date	
Theory Weight	1.495 kg/m Lb/ft	Scale	1:1	Series	TR
Out Perimeter	285.9 mm in	Finish		Delivery	Theory weight 2 / Bundle
Circumscribed About circle	ø82.4 mm in	Standard	GB 5237.1-2017	Precision	High Pre-cision Edition A

CUSTOMER	Customer Draw No.	
Signed by	Our Draw No.	TR1000



广西瑞祺丰新材料有限公司
Guangxi Ruiqi Feng New Material Co., Ltd.
TEL: 13908000771 E-mail: info@huijiansu-artist.com

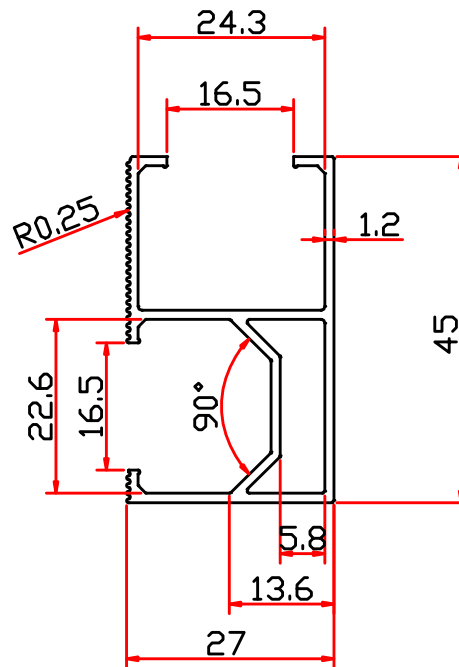

1. This drawing is consistent with the customer's "samples / drawings", and the Demander shall be responsible for any patent or trademark matters.
2. If it is matched with other profiles or accessories, it is necessary to indicate or provide accessories. Otherwise, the assembly problems caused shall be borne by the customer.
3. The customer confirms the drawings, including confirming and approving the drawings, tolerances, acceptance standards, weight, decorative surface area and other information on the drawings.

Area of Exposed Surface: 0.153 m²/m

Unspec. Thickness: 1.2 mm in Unspec. Radius: R0.3 mm in

Drawn by LCQ
Date 2023.06.05

Checked by
Date

Confirmed by
Date

Series US Profile appellation

Delivery Theory weight 4 /Bundle

Precision High Pre-cision Edition A

Sectional Area	192.13 mm ² in ²	Alloy/Temper	6063-T6
Theory Weight	0.523 kg/m Lb/ft	Scale	1:1
Out Perimeter	255.75 mm in	Finish	
Circumscribed About circle	ø52.3 mm in	Standard	GB 5237.1-2017

1. * Important dimension.
2. () Referenced dimension.

GENERAL TOLERANCES

DIMENSION	LENGTH			BETWEEN HOLES AND PINS	ANGLES	RADIUS
	0-30	30-120	120-			
TOLERANCE	±0.2	±0.3	±0.4	±0.1	±0.5°	±0.1

CUSTOMER	Customer Draw No.	Our Draw No.	US100
Signed by			



广西瑞祺丰新材料有限公司
Guangxi Ruiqi Feng New Material Co., Ltd.
TEL: 13908000771 E-mail: info@huanan-artist.com